

Pitney Bowes Postage Meter

Instructions for using the SEAL ONLY function.

Ensure that the reservoir contains fluid. If not, please use the fluid in the little bottle stored in the right hand side of the cabinet below the meter before sealing.

1. Starting at the home page, press "Print on Envelopes"

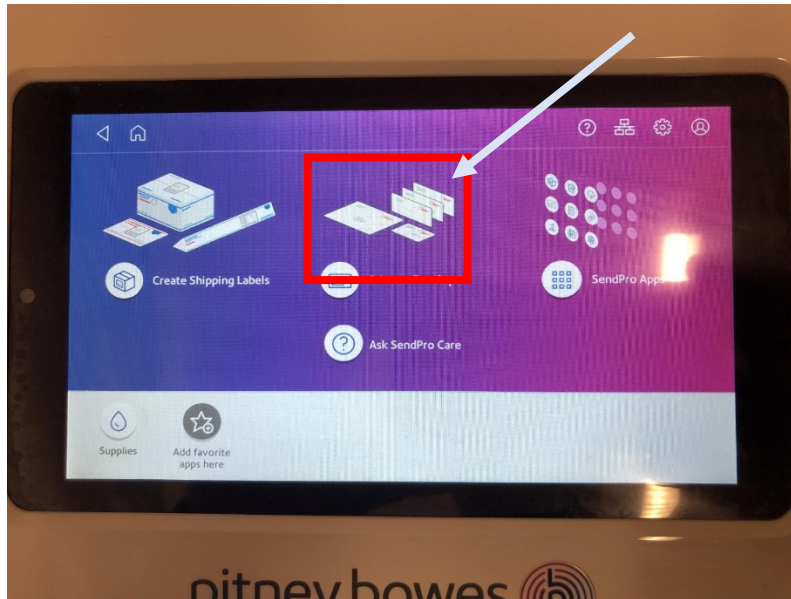

2. Under "Reset to Default" drag the right-hand side of the screen up until "Postage Printing" is fully visible in the "Print Mode" section.

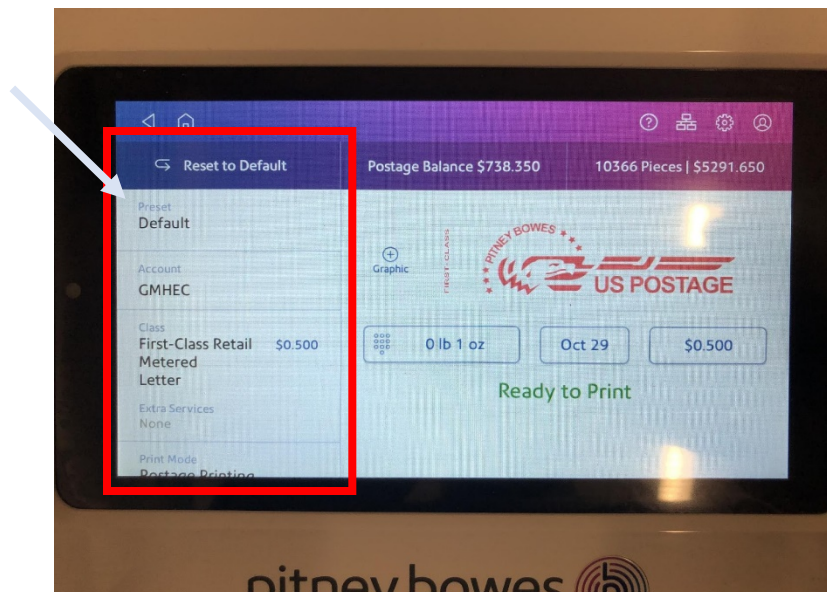

3. Touch "Postage Printing"

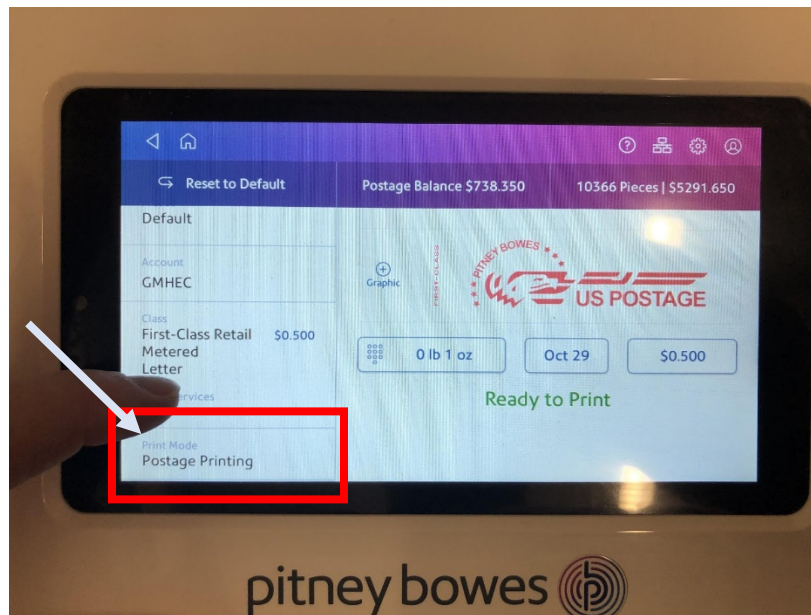

4. Drag the right-hand side of the screen up until "Seal Only" is visible.

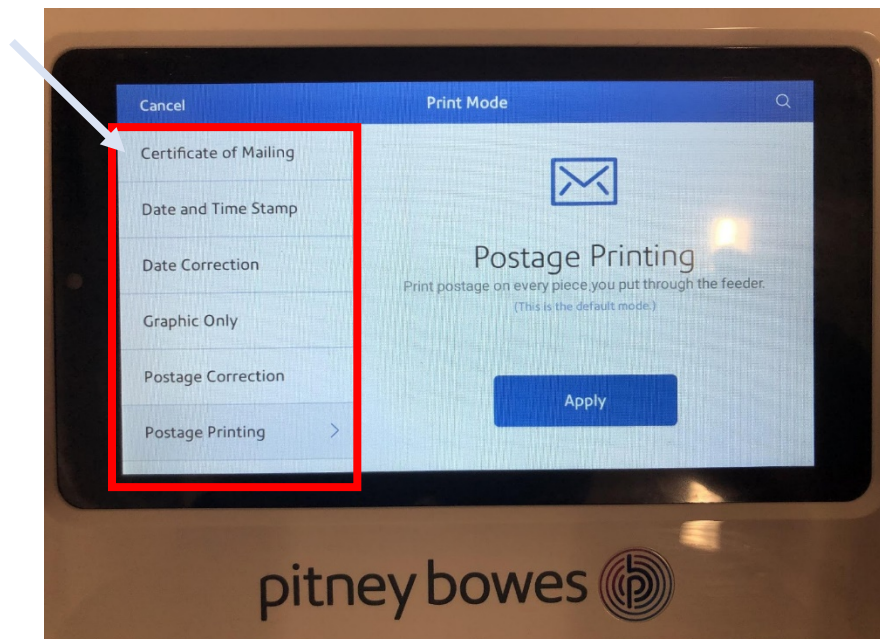

5. Touch "Seal Only"

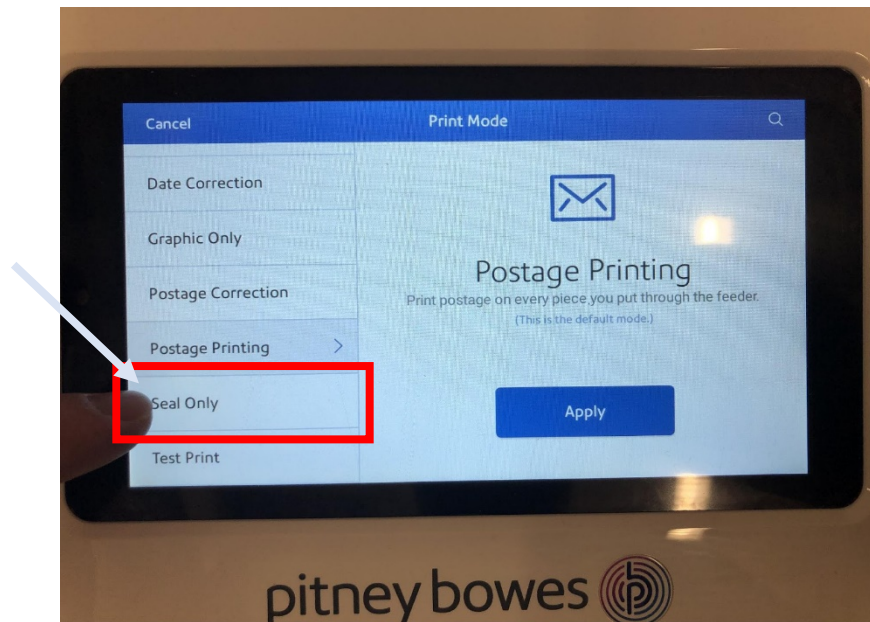

6. Touch "Apply"

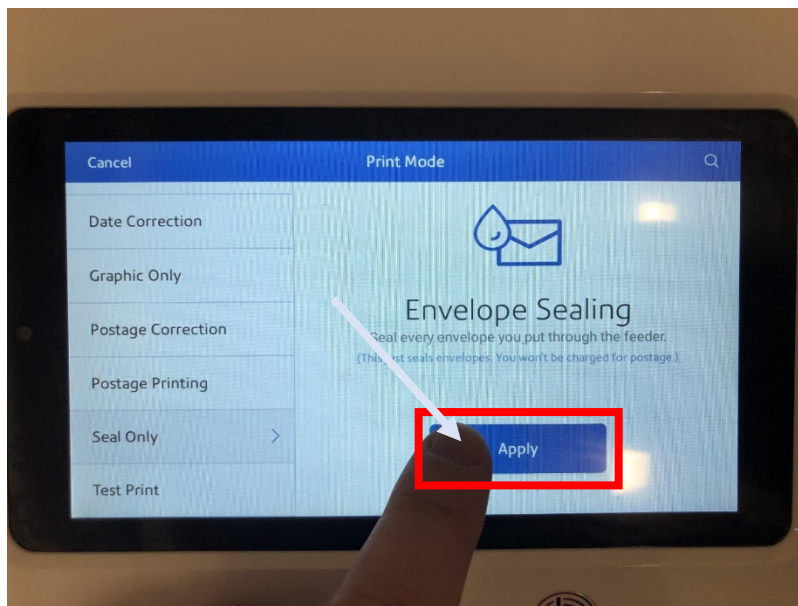

7. Proceed to feed envelopes through the meter as you would to print postage.

